

Vakuum Lifter 7005-PKW/E

1-circuit vacuum lifting
device according to EN
13155

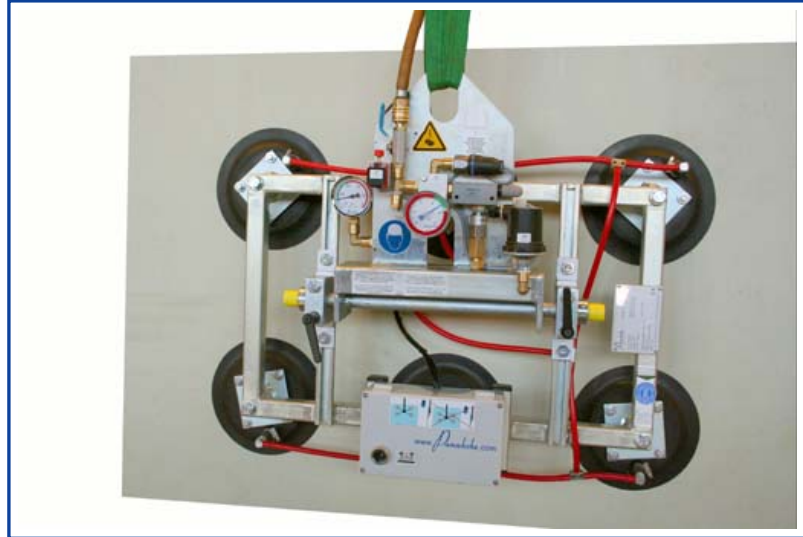

for glazing of car wind screens in the work shop area

Description

- **1-circuit-vacuum system**
- the vacuum circuit has a reservoir with non-return valve, vacuum switch and control vacuum meter
- **closed vacuum circuit**
prevents loss of vacuum at vompresed air failurel
- **power failure monitoring system**
- acoustic signal
reports low vacuum and compressed air failure
- angle of inclination adjustable via a clamping device
- movably attached suction cups to accommodate slightly curved vehicle windows
- fixed distance between the suction cups

Vacuum generation

- through built-in venturi jet,
at least 6 bar compressed air is required for operation
- optionally air pressure economy circuit
- optionally quick-release function

Operation

- ON/OFF directly on the device
- SUCTION via a touch valve
- RELEASE via two touch valves
- tilting clamping device via 2 clamping levers

Suspension: crane eye at the carrying frame
Load capacity : 140 kg / 210 kg
Colour: galvanised



suitable for lifting		
material properties	gas-tight	
surface	smooth, slightly structural	
e. g.	car, bus or truck windscreens	
suction cup type	540	
diameter in action approx. mm	200	
quality of suction cups	black rubber abrasion possible up to 80° C heat resistant	
number of suction cups	4	6
carrying capacity on smooth and clean surface at 60 % vacuum in-company kg	140	210
outer distance of the suction cups approx. mm	810 x 560	
dead weight approx. kg	22 kg	24 kg
air pressure connection	9 mm	
Item No.: 7005-PKW/E...	-04	-06
accessories on request		
Item No.: 540-SCHUTZ	protection cap for suction cup 540	
Item No.: OPT-DLSpar	air pressure economy circuit – saves approx. 50 % of of the compressed air consumption	
Item No.: OPT-SLF	quick-release function – with full supply pressure	



Vakuum Lifter 7005-PKW/E with 4 suction cups 540

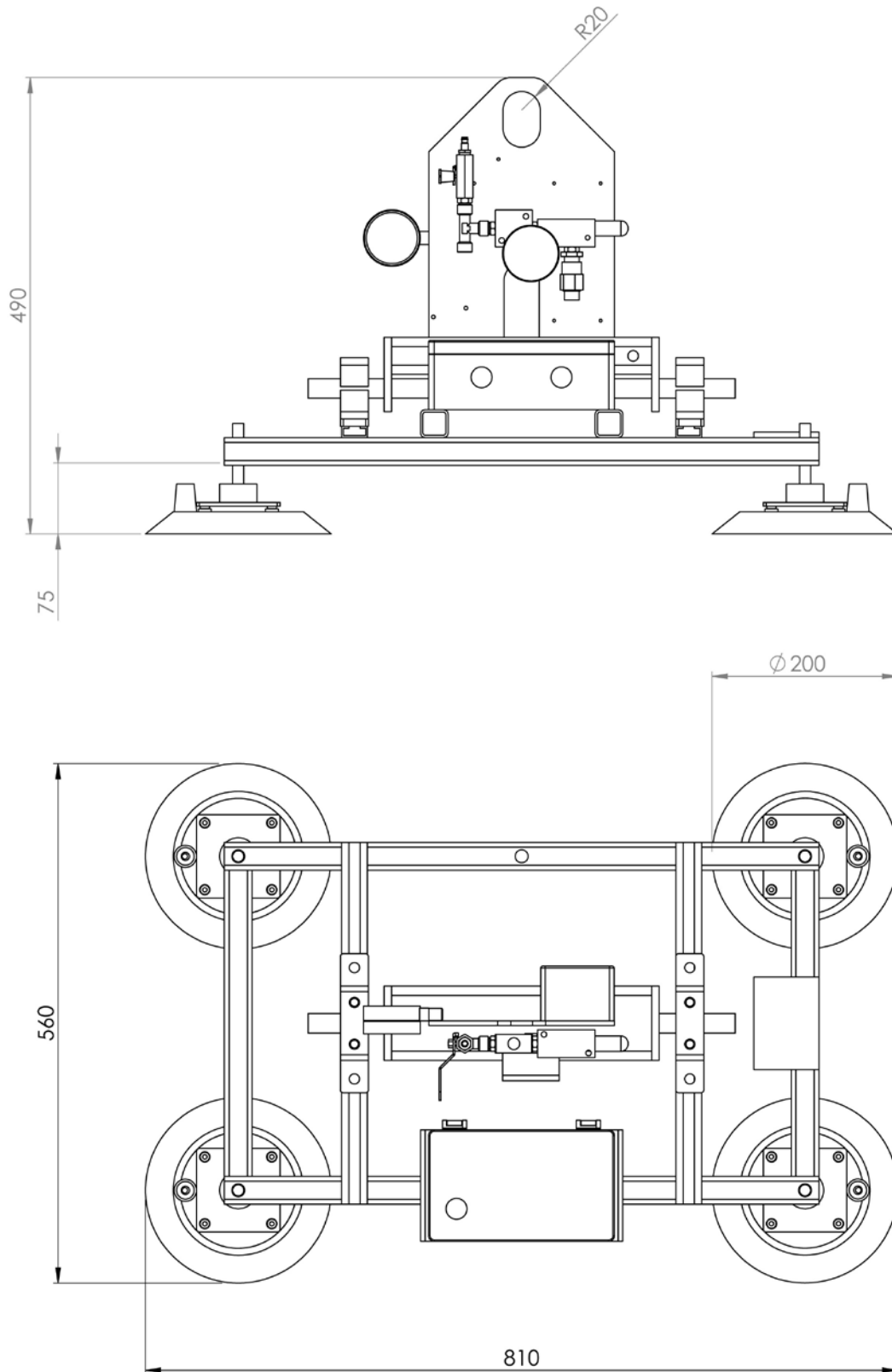

Vakuum Lifter 7005-PKW/E with 6 suction cups 540

